



## Shomal's series FLB linear fixtures

are designed for use with fluorescent lamps or LED technology . the FLB is constructed with a robust aluminum housing and an impact-resistant borosilicate glass tube, providing extreme durability and reliability in zone 1,2, 21 and 22 hazardous areas.



Featuring an IP66 rating, the FLB is designed for use in outdoor and indoor hazardous areas where moisture or corrosion may be a problem.

An optional external reflector provides application-specific light distribution.

The FLB is available with LED technology (3000 and 6000 lumens) or fluorescent.

Lamps (2x18 and 2x36) An optional emergency battery back-up is available for both models.

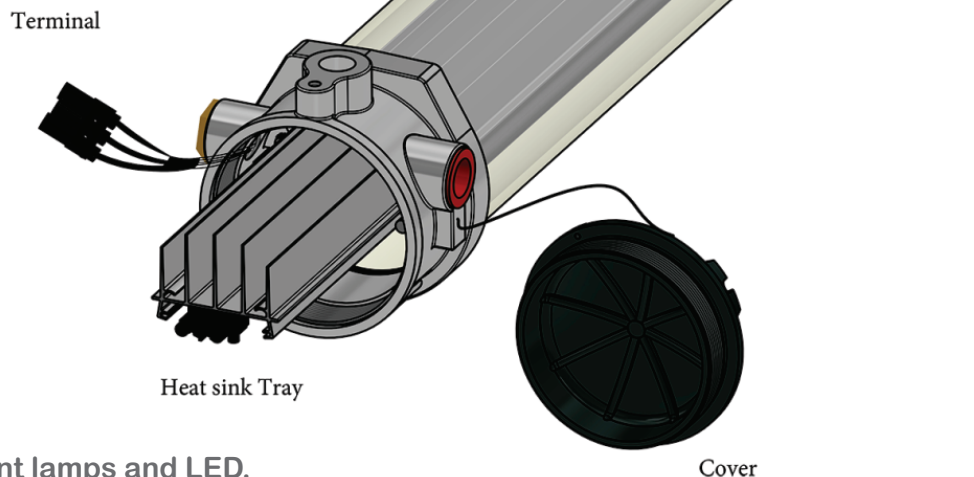

### Features

- Robust Ex-d housing.
- Designed for florescent lamps and LED.
- Easy opening due screw cover on ends.
- Large terminal compartment.
- silicon gaskets resistant to acids.

1

2

3

4

5

6

7

8

9

10

# LED Strip Lighting Fixtures

FLB L Series  
FLB L NI Series



Zone 1,2,21,22



## SPECIFICATION

Type	FLB L 220
Marking	⊕ II 2G Ex db op is IIC T6 Gb ⊕ II 2D Ex op is tb IIIC T85°C Db
Standards	EN 60079-0:2012; EN 60079-28 EN 60079-1:2014; EN 60079-31
EU-type Examination Certificate No.	IMQ 20 ATEX 001X
Degree of protection	IP66
Enclosure material	Aluminum
Enclosure color	Grey RAL7032 (body), RAL7043 (cover)
Protective cover / bowl	Borosilicate glass
Permissible ambient temperature	-30°C to +55°C
Light Source	LED Board
Rated Voltage	220VAC~ 240VAC
Rated Frequency	50/60 Hz
Power Consumption(±10%)	28W
Color Temperature	Neutral white-5000K
Power factor	>0.95
Circuit	Electronic driver -Constant current
Rated Current	0.11 ~ 0.13A
EMC Protection	Yes
Connection	Direct connection to terminal L,N,PE. 2.5 mm <sup>2</sup> /4 mm <sup>2</sup>
Earth stud	M5 External and internal earth connections
THD(total harmonic distortion)	<8%
Driver Performances	Over-Voltage protection: YES Over-Current protection: YES Short-Circuit protection: YES
Starting time(at 230 V, 50Hz)	0.8 S
Fixture lifetime	50.000 hours
Rated luminous flux	3895Lm
Entries	Direct Entries, 2 x 3/4" NPT (Metric thread are available on request by adaptor )
Ordering Details:	<ul style="list-style-type: none"> <li>• Wire guard</li> <li>• Cable gland</li> <li>• Installation kit for surface, pole, ceiling and suspension mounting</li> <li>• Through wiring system</li> <li>• Emergency battery pack</li> <li>• Exit sign(green-white)</li> </ul>

Type	Weight approx.	Type	A1	X	A2	A3
FLB 220	5.2 kg	FLB 220	736	579	148	141

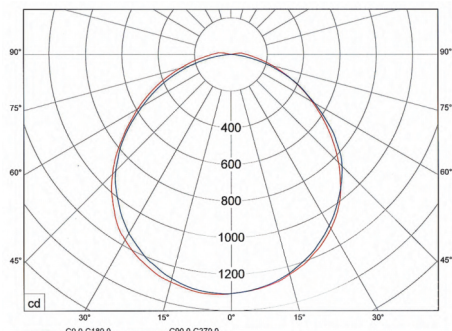
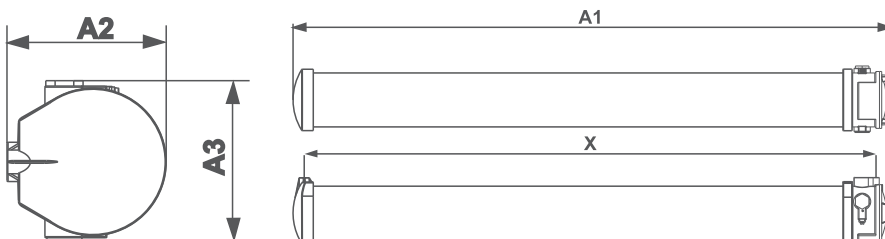

All information may be revised or changed by SHOMAL at anytime without prior notice or explanation.

1

2

3

4

5

6

7

8

9

10

# LED Strip Lighting Fixtures

FLB L Series  
FLB L NI Series



Zone 1,2,21,22

## SPECIFICATION

Type	FLB L 240
Marking	⊕ II 2G Ex db op is IIC T6 Gb ⊕ II 2D Ex op is tb IIIC T85°C Db
Standards	EN 60079-0:2012; EN 60079-0:2012/A11:2013; EN 60079-1:2014; EN 60079-28: 2015; EN 60079-31:2014
EU-type Examination Certificate No.	IMQ 20 ATEX 001X
Degree of protection	IP66
Enclosure material	Aluminum
Enclosure color	Grey RAL7032 (body), RAL7043 (cover)
Protective cover / bowl	Borosilicate glass
Permissible ambient temperature	-30°C to +55°C
Light Source	LED Board
Rated Voltage	220VAC~ 240VAC
Rated Frequency	50/60 Hz
Power Consumption(± 10%)	40W
Color Temperature	Neutral white-5000K
Power factor	>0.95
Circuit	Electronic driver -Constant current
Rated Current	0.16 ~ 0.22A
EMC Protection	Yes
Connection	Direct connection to terminal L,N,PE. 2.5 mm <sup>2</sup> /4 mm <sup>2</sup>
Earth stud	M5 External and internal earth connections
THD(total harmonic distortion)	<8%
Driver Performances	Over-Voltage protection: YES Over-Current protection: YES Short-Circuit protection: YES
Starting time(at 230 V, 50Hz)	0.8 S
Fixture lifetime	50.000 hours
Rated luminous flux	6581Lm
Entries	Direct Entries, 2 x 3/4" NPT (Metric thread are available on request by adaptor )
Ordering Details:	<ul style="list-style-type: none"> <li>• Wire guard</li> <li>• Cable gland</li> <li>• Installation kit for surface, pole, ceiling and suspension mounting</li> <li>• Through wiring system</li> <li>• Emergency battery pack</li> <li>• Exit sign(green-white)</li> </ul>

Type	Weight approx.	Type	A1	X	A2	A3
FLB 240	8.3 kg	FLB 240	1330	1270	148	141

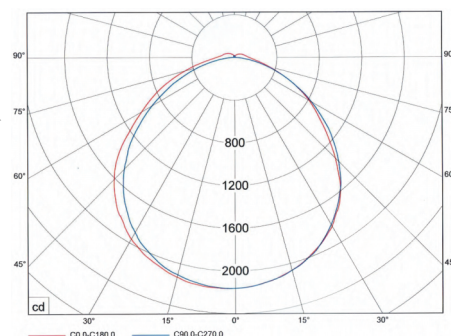

All information may be revised or changed by SHOMAL at anytime without prior notice or explanation.

[www.shomal.com](http://www.shomal.com)

# Lighting Accessories



Zone 1, 2, 21, 22

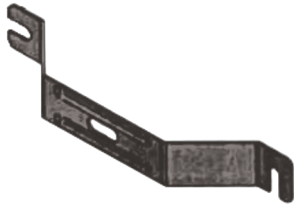
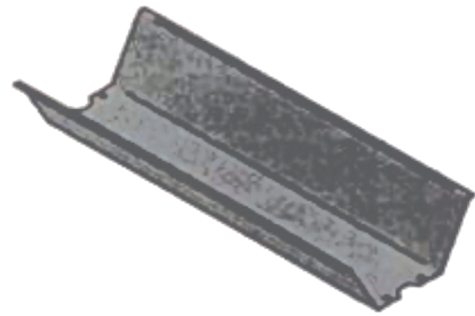

Description
Ceiling mounting bracket
Material
Galvanized steel / Stainless Steel / Painted Steel Sheet

Description
External Reflector
Material
Galvanized steel /Stainless Steel

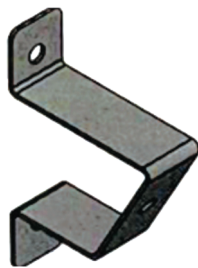

Description
Protect light wall suspension with 60° angle
Material
Galvanized Steel / Stainless Steel

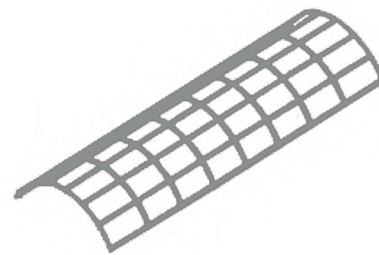

Description
External Guard 180°
Material
Diameter of rod; Stainless steel/ Galvanized steel(according to order):3mm Diameter of rod; pewter(according to order)



Description
Eye bolt proectlight fitting mounting
Material
Steel/Galvanized Steel

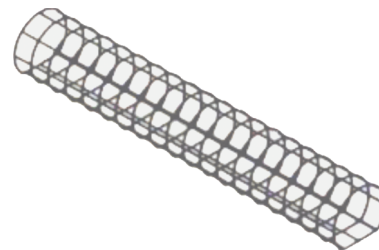

Description
External Guard 360°
Material
Diameter of rod; Stainless steel/ Galvanized steel(according to order):3mm Diameter of rod; pewter(according to order)

- 1
- 2**
- 3
- 4
- 5
- 6
- 7
- 8
- 9
- 10

All information may be revised or changed by SHOMAL at anytime without prior notice or explanation.

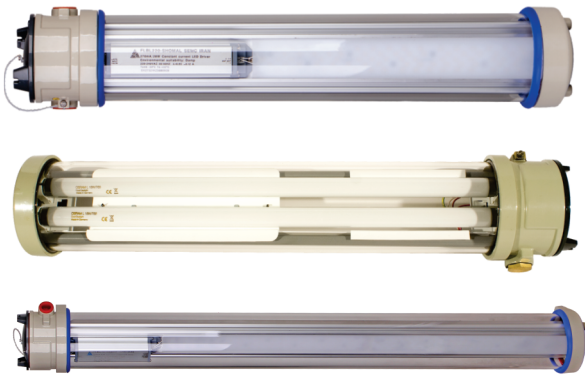

# Lighting Accesories



Zone 1,2,21,22

► entries

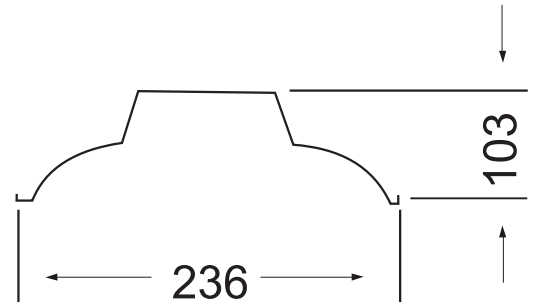
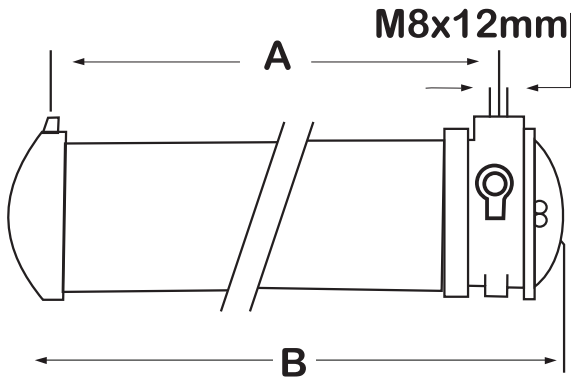

Reflector RAB

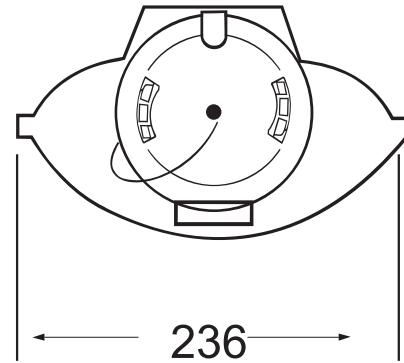

Reflector with wire guard GRAB

	A	B
AB 12220	652	707
AB 12240	1265	1320
AB 12265	155	1620
AB 12236 PL	652	707

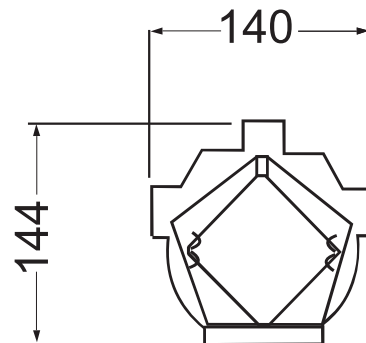
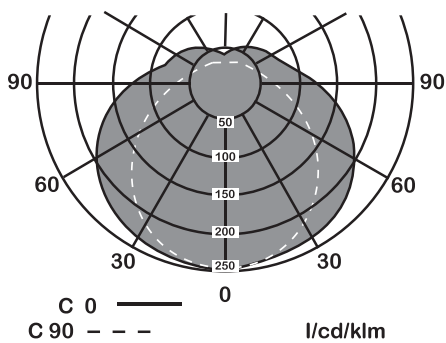
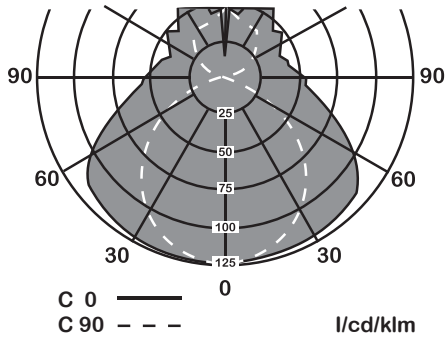

All information may be revised or changed by SHOMAL at anytime without prior notice or explanation.

- 1
- 2
- 3
- 4
- 5
- 6
- 7
- 8
- 9
- 10